

TEMPS 1 ACTIVATION OF THE PROJECT

Corrèze-house of Ussel + Danse hall/auditorium + Annex for a future equipment
Investment of the Limoux slab

- A space dedicated to the Corrèze-house, space of dialog on :
- urban projects in progress (developpement of Ussel, question of parking in the center of Ussel.)
 - accompaniment of cooperative projects
 - the project of Corrèze-houses : the network
 - current or futur events : fairs, shows...

/danse hall and auditorium (all generations.)
 /annex for the futur equipment below restaurant of the EHPAD

TEMPS 2 A PUBLIC SPACE AT THE RIGHT MEASURE

Adaptable public space
Investment of the showground

- stairs, thresholds, seuils, ramps, walls, as precious objects, each one solving both the relation between a building and public space, and a question of daily paths through the site
- the rest of the space is made with a very economical way

TEMPS 3 BUILDING DWELLINGS

Housing for young workers

between town center and future public space on the hill

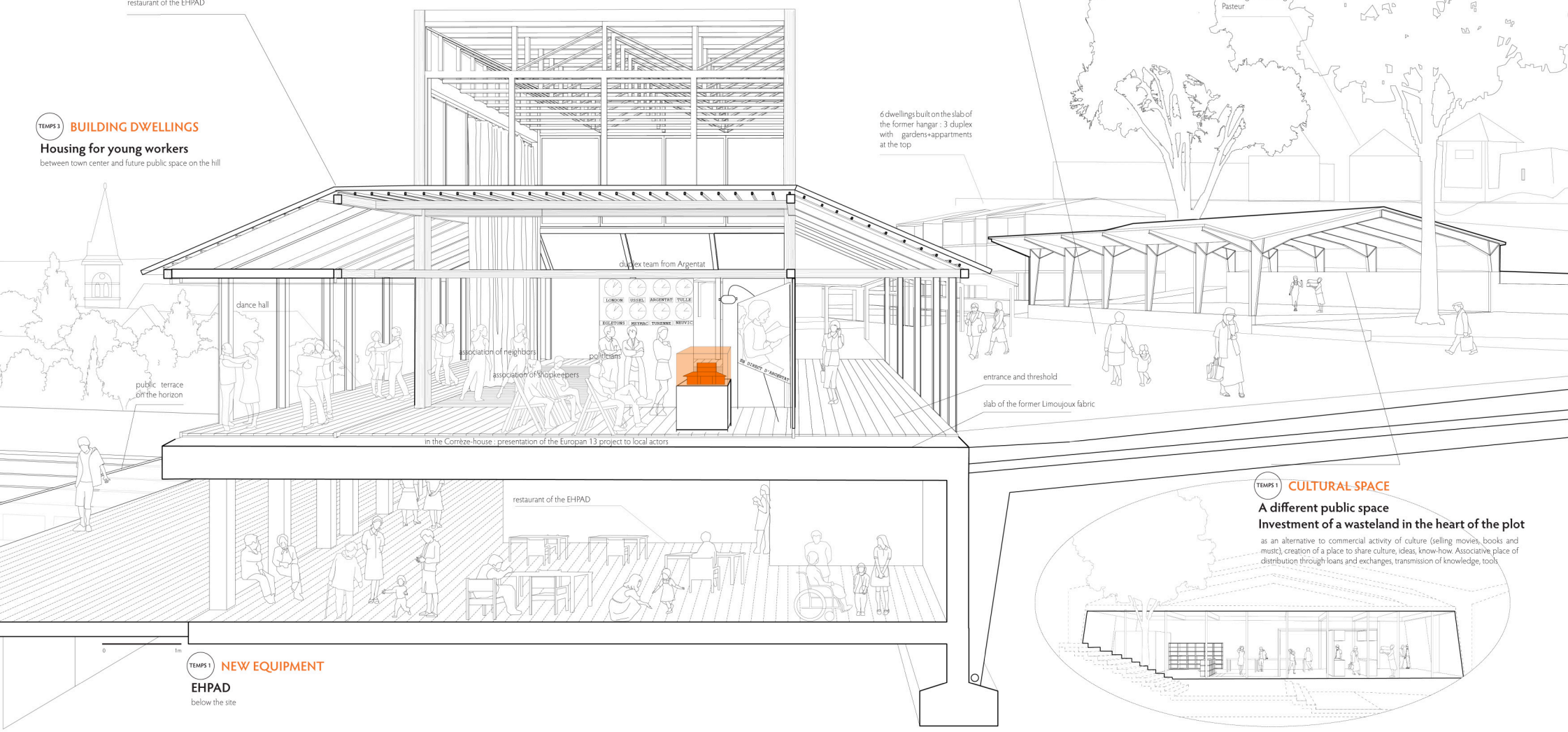

TEMPS 1 CULTURAL SPACE

A different public space
Investment of a wasteland in the heart of the plot

as an alternative to commercial activity of culture (selling movies, books and music), creation of a place to share culture, ideas, know-how. Associative place of distribution through loans and exchanges, transmission of knowledge, tools

TEMPS 1 NEW EQUIPMENT

EHPAD
 below the site

