

**TEMPS 2 STRUCTURING PUBLIC SPACE**

**Along the dock of the train station**

- promenade with trees
- requalification of the terrace of restaurant "Le Vieux Séchoir" sur le mail
- access to the station building

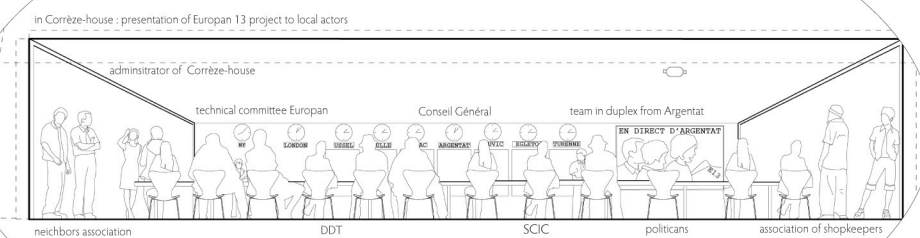

**TEMPS 1 ACTIVATION OF THE PROJECT**

**Corrèze-house of Turenne**  
**Investment of the former station maintenance building**

/ space dedicated to the House Corrèze, in place of dialog:

- urban projects in progress (save the listed heritage, tourism development, agricultural projects, ...)
- support for the cooperative housing
- architectural and landscape convention of public spaces
- revision of the PLU
- project of Corrèze-houses: networking
- current and future events: European project, Summer Festivities, Opening of the fishing period, large flea market

/ temporary accommodation space

- home of candidates for cooperative housing

/ workspace

- cooperative housing assembly meeting

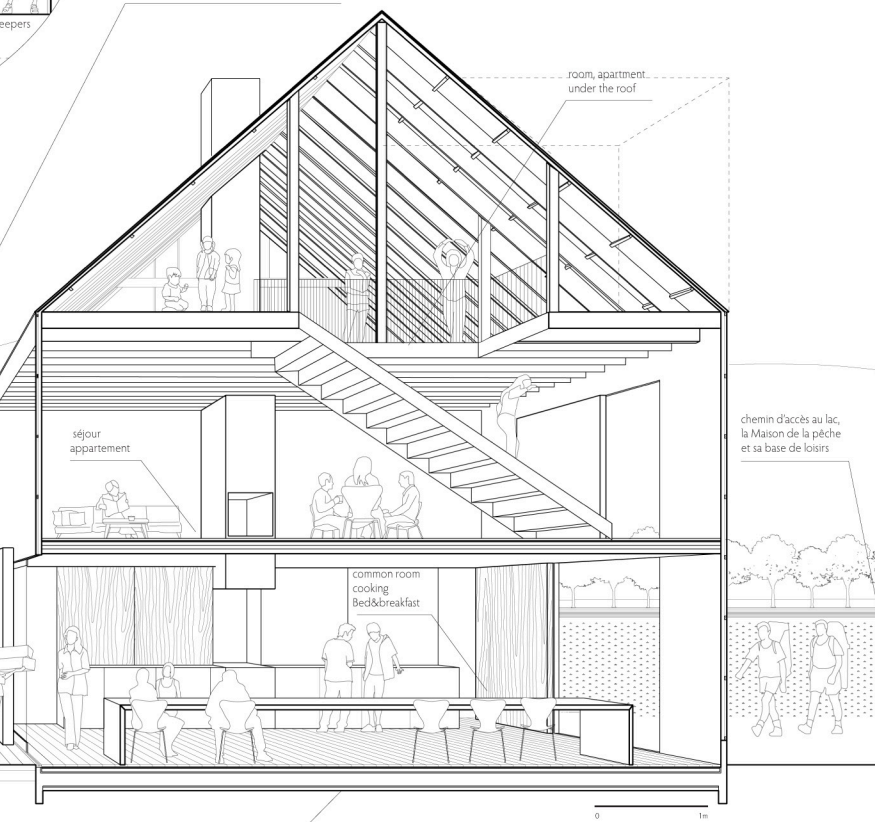
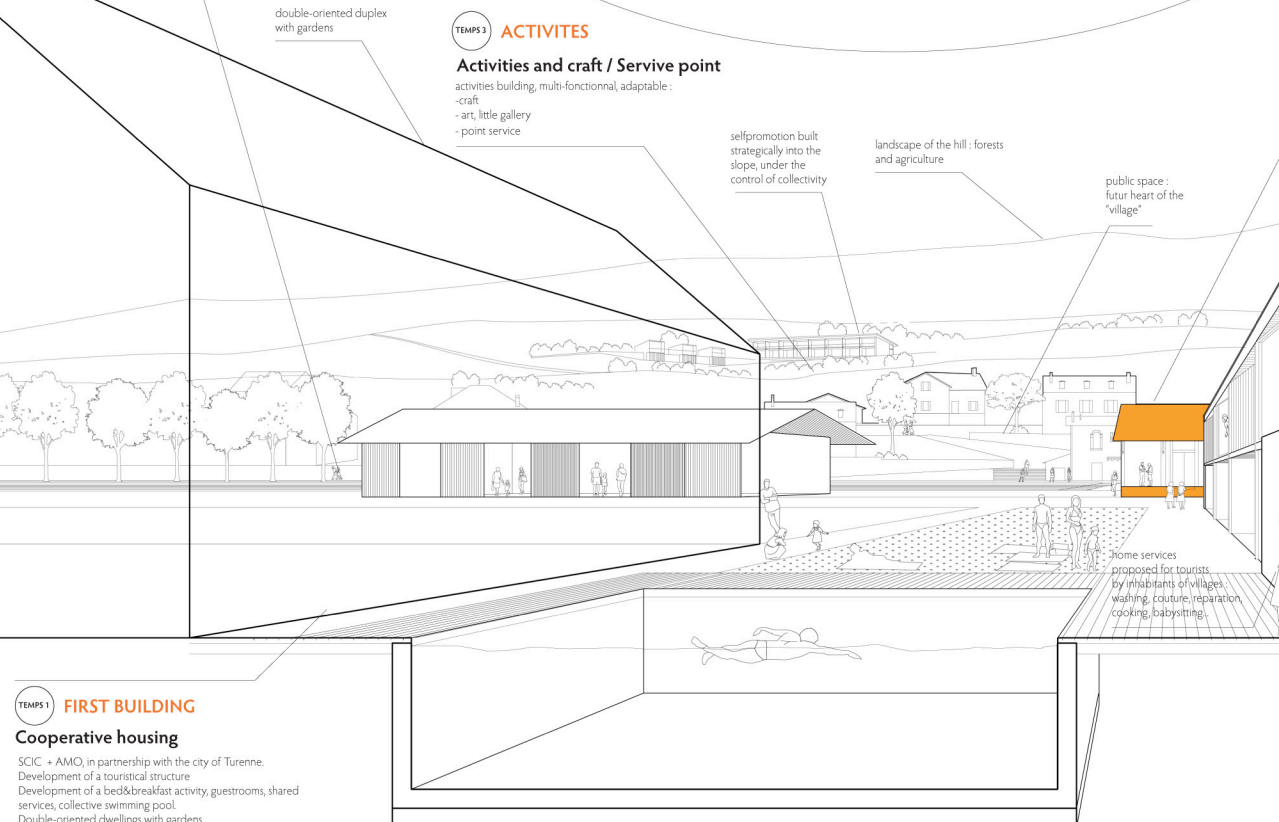

**TEMPS 1 FIRST BUILDING**

**Cooperative housing**

SCIC + AMO, in partnership with the city of Turenne.

Development of a touristical structure

Development of a bed&breakfast activity, guestrooms, shared services, collective swimming pool

Double-oriented dwellings with gardens

**TEMPS 3 COMMON SPACES FOR TOURISTS**

**Touristical accomodation**

Accommodation, apartments for rent in vis-à-vis with dwellings managed by SCIC:

- restroom
- Bed&breakfast
- agri-tourism

Welcoming future inhabitants collaborating with other projects in Turenne

